

ARVORE EXISTENTE
A SER MANTIDA

PALMEIRA EXISTENTE
A SER MANTIDA

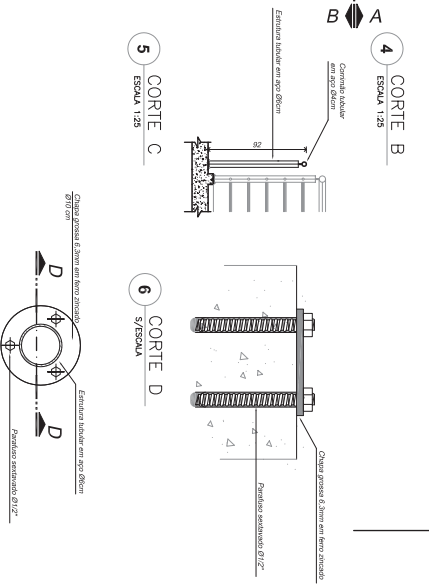
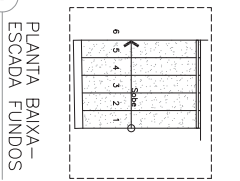

4 CORTE B
ESCALA 1:25

5 CORTE C
ESCALA 1:25

6 CORTE D
ESCALA 1:25

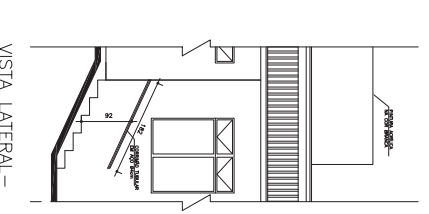

10 VISTA LATERAL -
CORRIMÃO FUNDOS
ESCALA 1:50

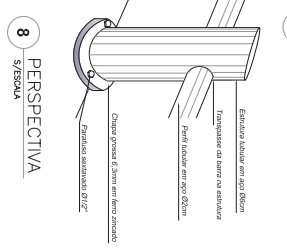

8 PERSPECTIVA
S/ESCALA

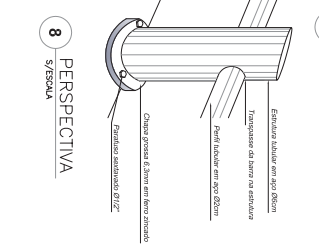

7 VISTA SUPERIOR -
ESTRUTURA
ESCALA 1:25

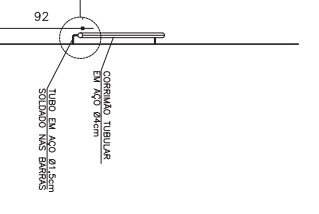

11 VISTA FRONTAL -
CORRIMÃO FUNDOS
ESCALA 1:30

2 CORTE A
ESCALA 1:25

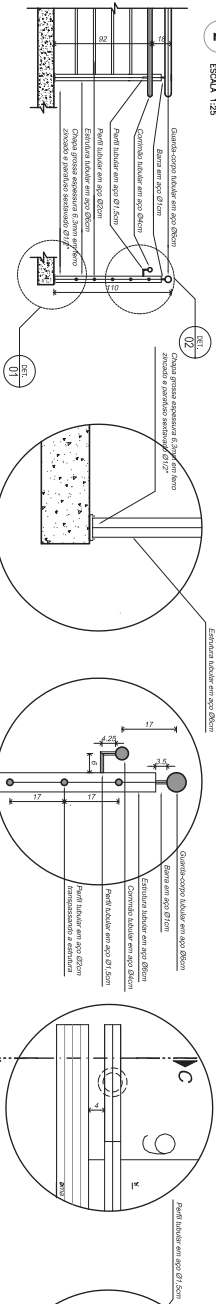

3 DETALHE GERAL
ESCALA 1:25

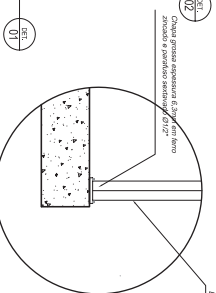

DETALHE 1

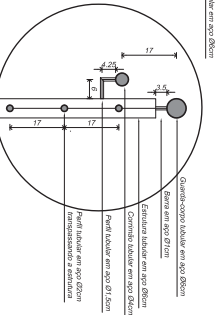

DETALHE 2

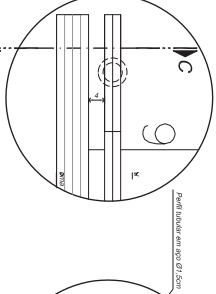

DETALHE 3

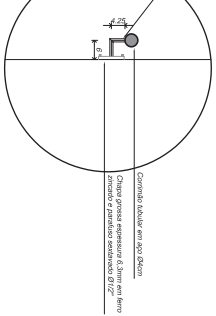

DETALHE 4

		<p>PROJETO DE SERRALHERIA</p> <p>DETALHAMENTO ESCADA DE ACESSO, CORRIMÃO, CORREDO E CORRIMÃO</p>	<p>PROJETO DE SERRALHERIA</p> <p>Arquiteto Responsável: Flávio de Souza Santos</p> <p>Arquiteta Responsável: Mariana de Souza Santos</p>
		<p>PROJETO DE SERRALHERIA</p> <p>Arquiteto Responsável: Flávio de Souza Santos</p> <p>Arquiteta Responsável: Mariana de Souza Santos</p>	<p>PROJETO DE SERRALHERIA</p> <p>Arquiteto Responsável: Flávio de Souza Santos</p> <p>Arquiteta Responsável: Mariana de Souza Santos</p>
<p>PROJETO DE SERRALHERIA</p> <p>Arquiteto Responsável: Flávio de Souza Santos</p> <p>Arquiteta Responsável: Mariana de Souza Santos</p>	<p>PROJETO DE SERRALHERIA</p> <p>Arquiteto Responsável: Flávio de Souza Santos</p> <p>Arquiteta Responsável: Mariana de Souza Santos</p>	<p>PROJETO DE SERRALHERIA</p> <p>Arquiteto Responsável: Flávio de Souza Santos</p> <p>Arquiteta Responsável: Mariana de Souza Santos</p>	<p>PROJETO DE SERRALHERIA</p> <p>Arquiteto Responsável: Flávio de Souza Santos</p> <p>Arquiteta Responsável: Mariana de Souza Santos</p>

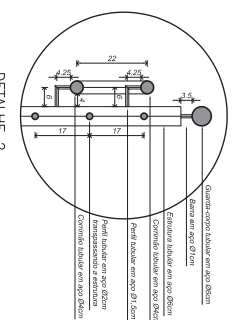
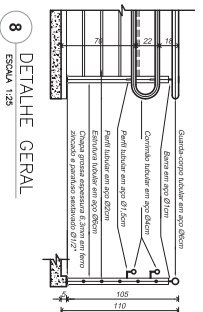
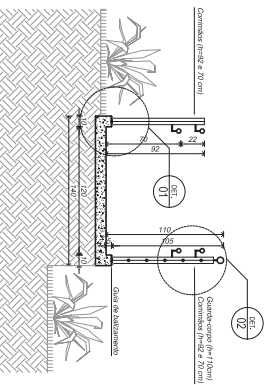
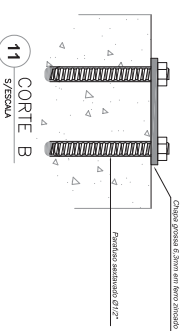
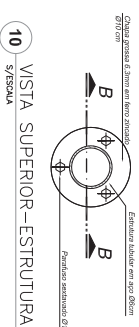
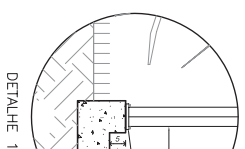
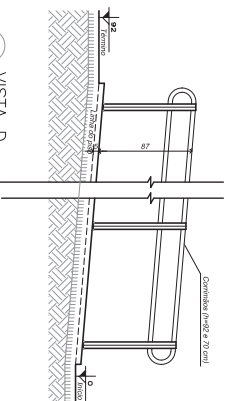
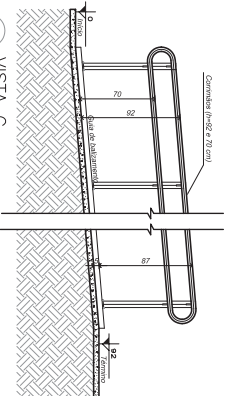
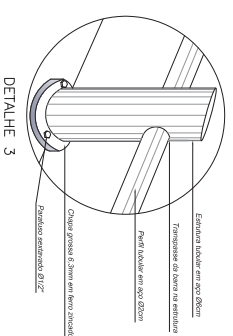
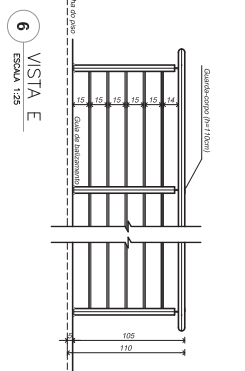
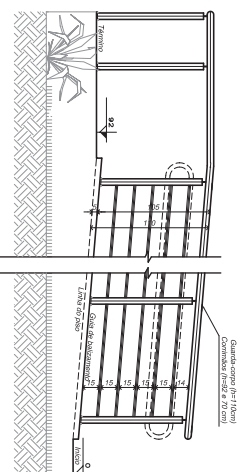
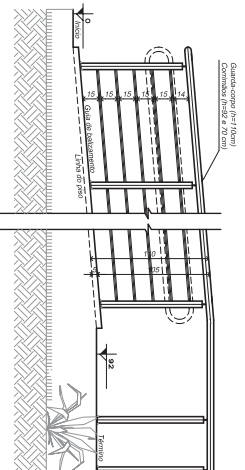
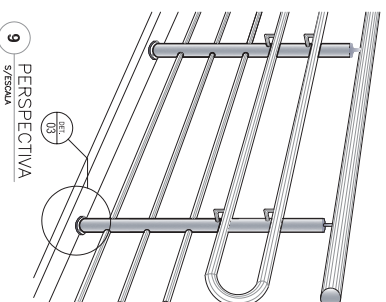
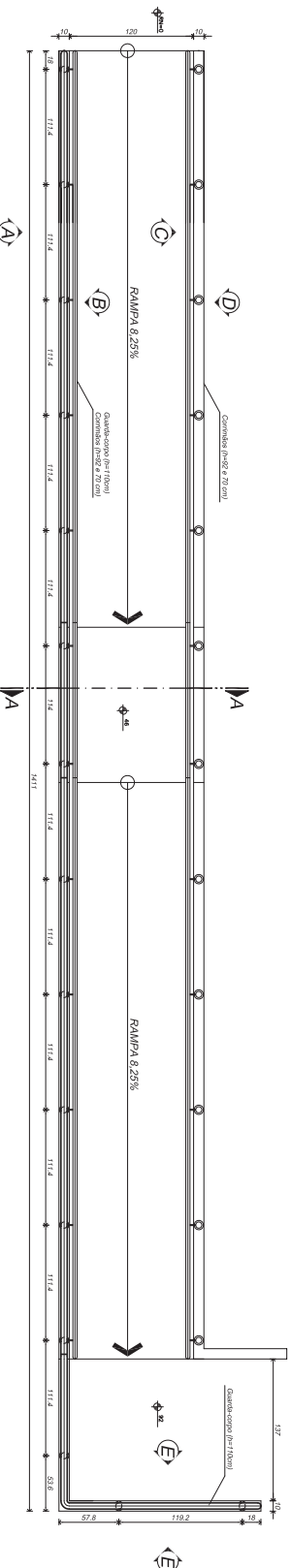

ATENÇÃO: AS ESPECIFICAÇÕES DOS MATERIAIS SERÃO EXAMINADAS NO LABORATÓRIO DESCRITO DE CADA UM DOS FORNECEDORES.		
Tribunal Regional Eleitoral de Santa Catarina		
PROJETO DE SERRALHERIA		
COORDENADOR GERAL Kátia Luzia Pereira Arquiteta responsável pelo projeto	COORDENADOR DE PROJETOS Rodrigo Pálissani Arquiteto responsável pelo projeto	ENGENHEIRO RESPONSÁVEL Felipe Schmidt Perinotto Técnico responsável pelo projeto
LOCAL: TRAVESSA 1ª RIBANDA ELÉTRICA Nº772 ESCOLA COM. RA. DOUR. DE CAJAS - TIMBÓI LOCAL DO PROJETO: TRAVESSA 1ª RIBANDA ELÉTRICA Nº772 ESCOLA COM. RA. DOUR. DE CAJAS - TIMBÓI		
ENDEREÇO: TRAVESSA 1ª RIBANDA ELÉTRICA Nº772 ESCOLA COM. RA. DOUR. DE CAJAS - TIMBÓI CEP: 89014-905 CIDADE: TIMBÓI UF: SC	DATA: 05/03/2015 Nº: 06	INSTITUIÇÃO: TRIBUNAL REGIONAL ELEITORAL DE SANTA CATARINA Nº: 02/02